

FRIDURIT® Laboratory sinks made from Technical Ceramics

Technical description | April 2008

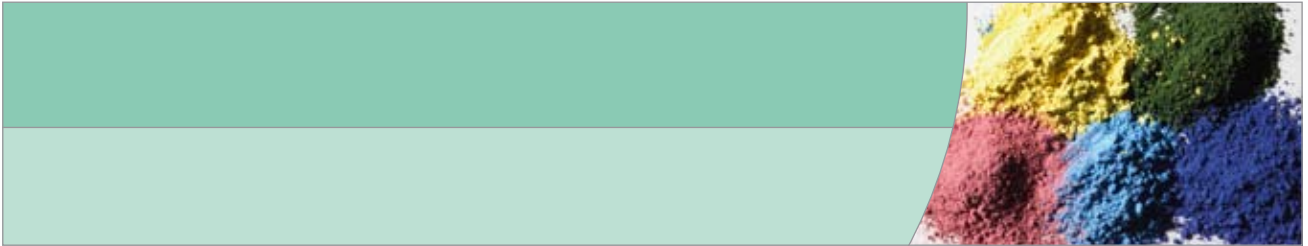

Safety and competence for successful laboratory projects

■ ■ ■ Legal notice

Editor



The specifications of our products are based on extensive technical development and on the results of stringent tests. We have gained experience in diverse areas of application over many years with FRIDURIT Technical Ceramics. However, the user is responsible for checking our specification and, if necessary, confirming the suitability by conducting his own tests.

We reserve the right to make technical alterations.

This catalogue is also available as a pdf file. Please refer to the following address:

FRIATEC Aktiengesellschaft
Section FRIDURIT Labortechnik
P.O. Box 710261
68222 Mannheim
Germany

phone: +49 621 486-1879
fax: +49 621 486-1605
e-mail: info-fridurit@friatec.de
internet: www.friatec.de

Besides the sink types described in this document others are available on request. We would be pleased to advise you further.

April 2008

FRIDURIT® Laboratory sinks ■■■

Technical description | Index

Introduction

■ Preface	04
■ FRIDURIT laboratory sinks	04
■ Glaze colours	05
■ Accessories	05

Standard sinks

■ Sinks without overflow	06
■ Cup sinks	07

Underfixed sinks

■ Underfixed sinks without overflow	08
■ Underfixed sinks with overflow	09
■ Underfixed double-sink with overflow	10

Free-standing sinks

■ Sinks without overflow	11
■ Sinks with overflow	12
■ Double-sink with overflow	13
■ Wall sink with overflow	14

Notes on installation

15

■ ■ ■ FRIDURIT® Laboratory sinks

Introduction

Preface

This technical description gives you extensive information about FRIDURIT laboratory sinks made from Technical Ceramics as a basis for your specifications.

Should you have any questions which this document does not answer, we would be pleased to advise you further. For contact details, please refer to the end of this brochure or to the internet on www.friatec.de.



FRIDURIT sink



Flush-mounted FRIDURIT cup sink

FRIDURIT® Laboratory sinks

FRIDURIT laboratory sinks are the perfect match for FRIDURIT laboratory benchtops. The semi-gloss surface is extremely durable and easy to clean. Even after years of intensive use, Technical Ceramics products maintain their flawless appearance.

FRIDURIT Technical Ceramics is produced using a time-consuming process from natural raw materials. The high density of the material provides maximum scratch and impact resistance. Further information, e.g. test certificates issued by independent institutions, are available on request.

Depending on the nature of your laboratory, we can provide free-standing sinks or sinks and cup sinks which can be installed in laboratory benchtops.

Our experience with the production of ceramic benchtops and sinks ensures top quality, together with flexible design.

Our technical specifications are based on the current DIN, EN and ISO norms.

Besides the sink types described in this document others are available on request. We would be pleased to advise you further.

Glaze colours

A wide range of colours as well as the availability of other colours to special order means FRIDURIT sinks made

from Technical Ceramics can satisfy the most exciting ergonomic and aesthetic demands.

Some examples of colour:

Glaze colour	Description	Order code
anthracite	similar to RAL 7043	Z
grey blue	similar to RAL 5014	B
diamond grey	---	X
grand canyon	russet	G
light grey	similar to RAL 7035	L
pearl	similar to RAL 9002	P
pure white	similar to RAL 9010	R
terracotta	similar to RAL 8017	T

Examples of our glaze colours are also shown on www.friatec.de.

Colour samples are available on request.

Accessories

A Polyethylene P-trap (stench trap) provides simple, reliable connections between the drainage system and the PE-outlet of the sink

Technical details:

P-trap for PE-outlet

outlet: compression fitting DN50

connection: 1½" x 100 mm

order code: BZS001

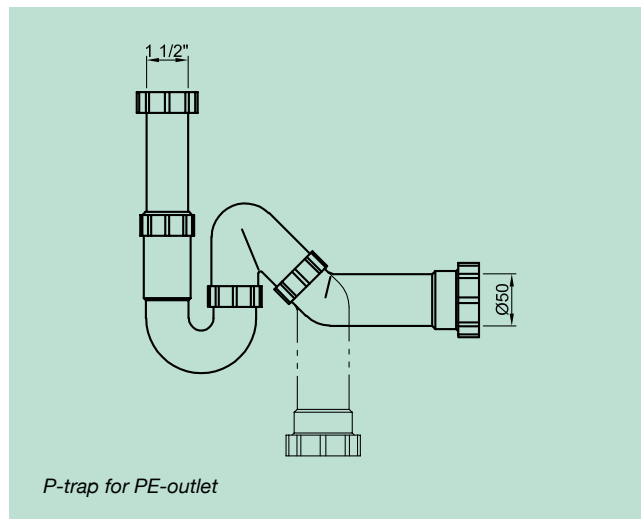

FRIDURIT® Laboratory sinks

Standard sinks

Sinks without overflow

FRIDURIT standard sinks without overflow are made from Technical Ceramics (chemical-technical stoneware). They are glazed inside and are equipped with a 1½" PE-outlet and a standpipe.

Application:

- as underfixed sink
- as sit-on sink
- as flush-mounted sink



Internal dims. (in mm)			External dims. (in mm)				Weight	Order code
l	b	t	L	B	h	S	kg	
400	400	250	460 ^{±3}	460 ^{±3}	273	11	25	VBES442●
500	400	250	560 ^{±3}	460 ^{±3}	273	11	26	VBES542●
600	400	250	660 ^{±3}	460 ^{±3}	273	11	32	VBES642●

● Please attach glaze colour. Sinks are only available uni-coloured.

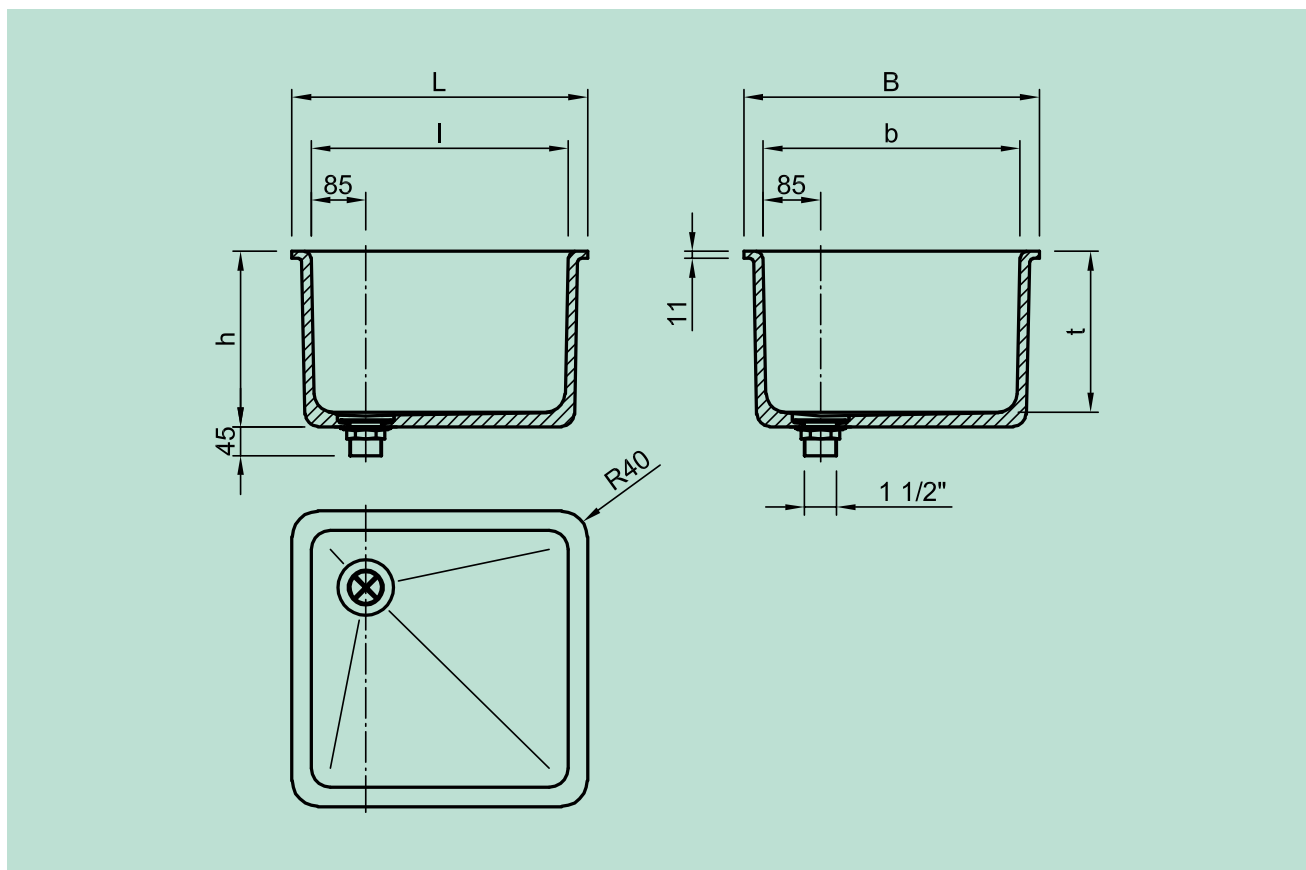

FRIDURIT® Laboratory sinks ■■■

Standard sinks

Cup sinks

FRIDURIT standard cup sinks are made from Technical Ceramics (chemical-technical stoneware). They are glazed inside and are equipped with a 1½" PE-outlet.

Application:

- as underfixed cup sink
- as sit-on cup sink
- as flush-mounted cup sink



Internal dims. (in mm)			External dims. (in mm)				Weight	Order code
l	b	t	L	B	h	S	kg	
ø105	---	112	ø145	---	125	7	1,5	VBPE111●
250	95	112	294	140	125	7	3	VBPE291●

● Please attach glaze colour. Sinks are only available uni-coloured.

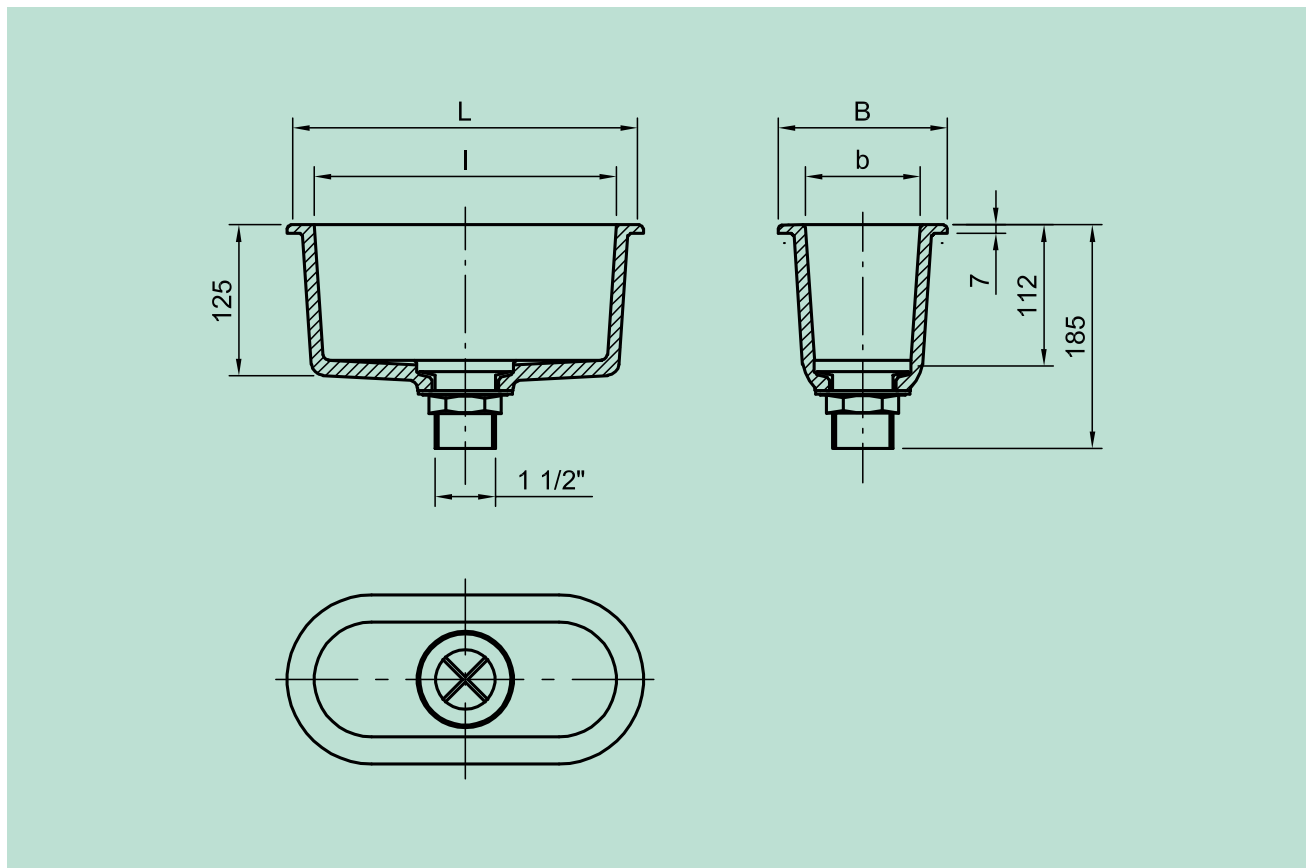

FRIDURIT® Laboratory sinks

Underfixed sinks

Underfixed sinks without overflow

FRIDURIT underfixed sinks without overflow are made from Technical Ceramics (chemical-technical stoneware). They are glazed inside and are equipped with a 1½" PE-outlet and a standpipe.



Internal dims. (in mm)			External dims. (in mm)			Weight kg	Order code
l	b	t	L	B	h		
400	400	250	476	476	272	26	VBPS442●-OUE
500	400	300	576	476	322	35	VBPS543●-OUE
600	400	300	676	476	322	38	VBPS643●-OUE
800	400	300	876	476	322	57	VBPS843●-OUE

● Please attach glaze colour. Sinks are only available uni-coloured.

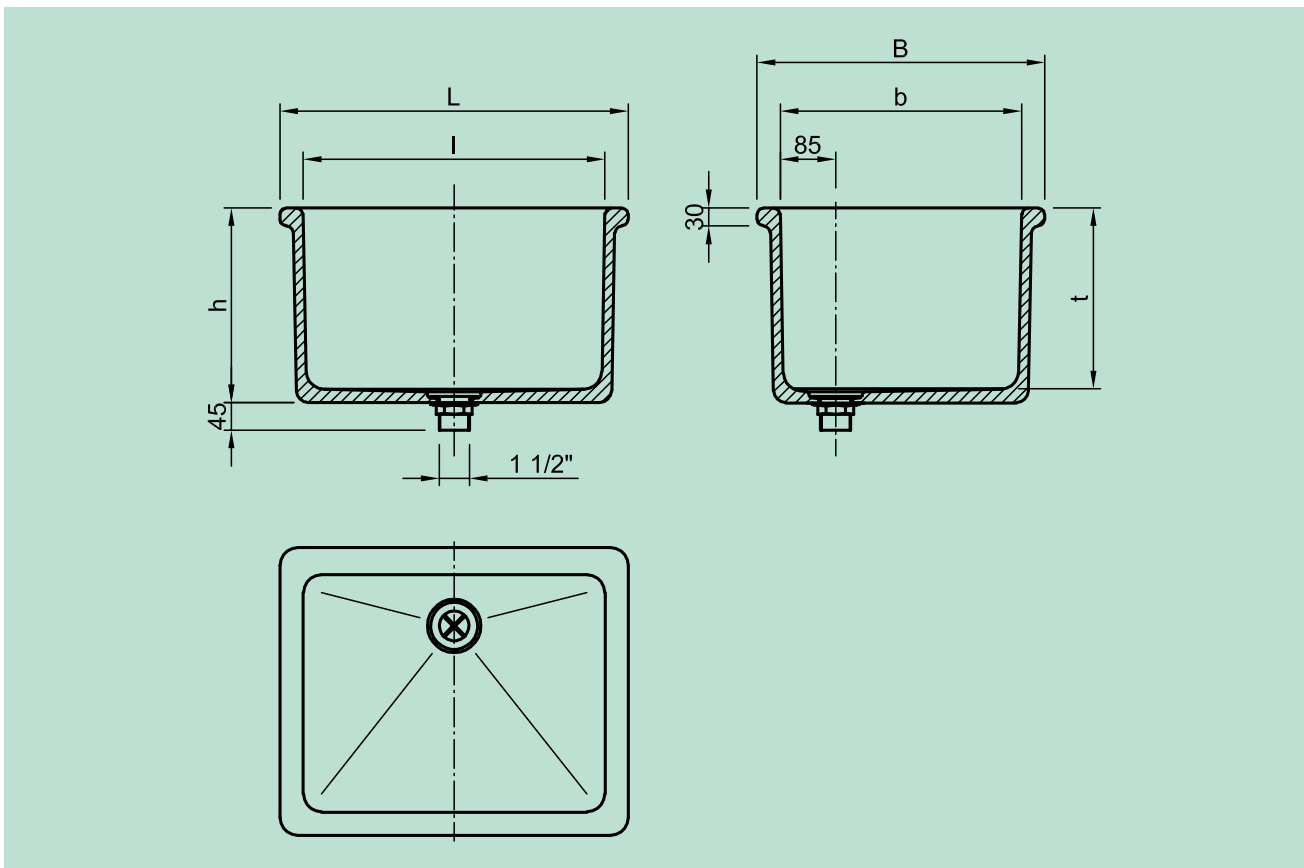

FRIDURIT® Laboratory sinks ■■■

Underfixed sinks

Underfixed sinks with overflow

FRIDURIT underfixed sinks with overflow are made from Technical Ceramics (chemical-technical stoneware). They are glazed inside and are equipped with a 1½" PE-outlet and a plug.



Internal dims. (in mm)			External dims. (in mm)			Weight kg	Order code
l	b	t	L	B	h		
350	350	300	420	420	322	28	VBPS333●
400	400	250	476	476	272	28	VBPS442●
500	400	300	576	476	322	37	VBPS543●
600	400	300	676	476	322	40	VBPS643●
800	400	300	876	476	322	59	VBPS843●

● Please attach glaze colour. Sinks are only available uni-coloured.

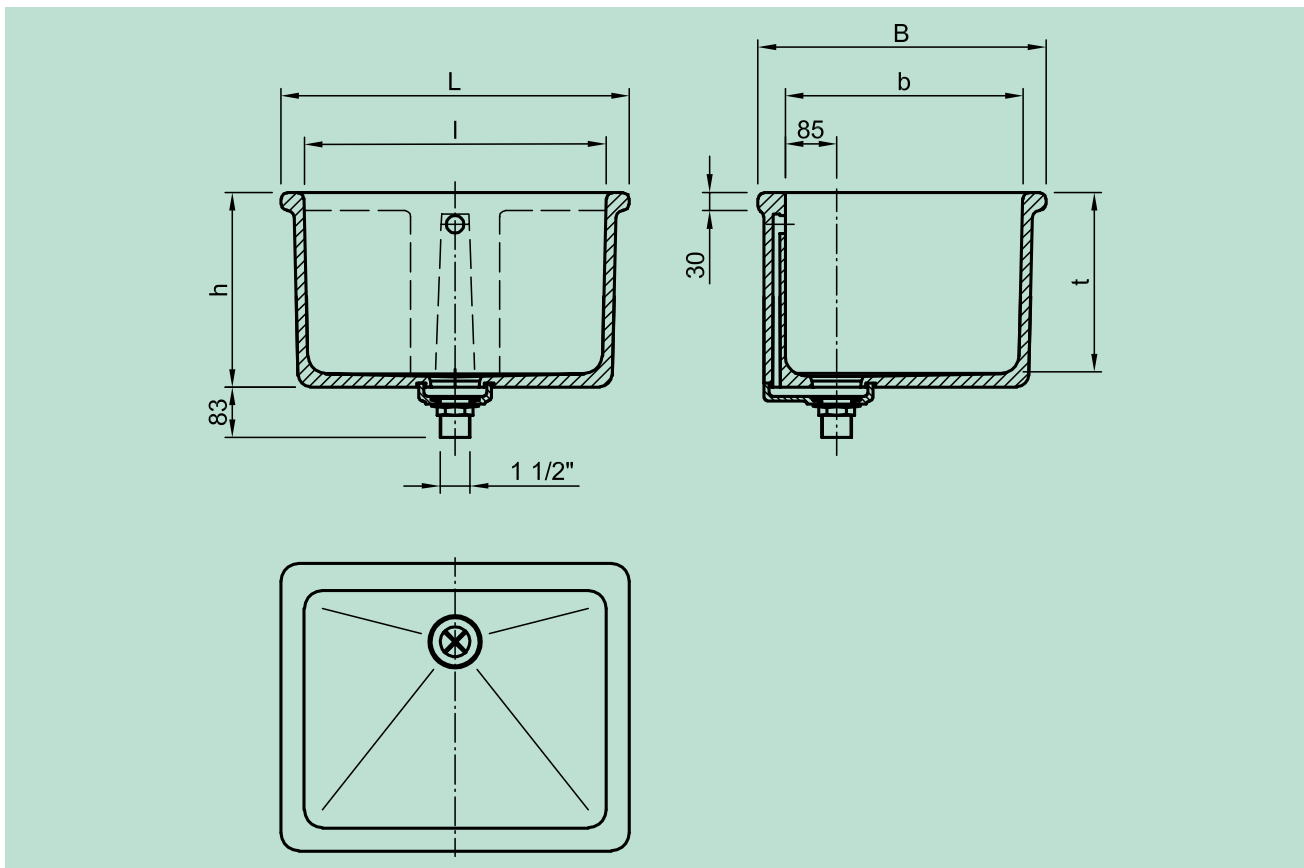

FRIDURIT® Laboratory sinks

FRIDURIT®

Underfixed sinks

Underfixed double-sink with overflow

FRIDURIT underfixed double sinks are made from Technical Ceramics (chemical-technical stoneware). They are glazed inside and are equipped with a 1½" PE-outlet and 2 plugs.

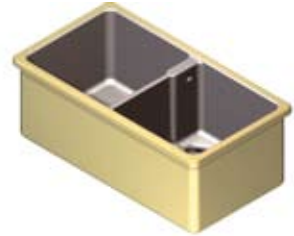

Internal dims. (in mm)			External dims. (in mm)			Weight kg	Order code
l	b	t	L	B	h		
810	410	300	880	485	322	65	VBPD843●

● Please attach glaze colour. Sinks are only available uni-coloured.

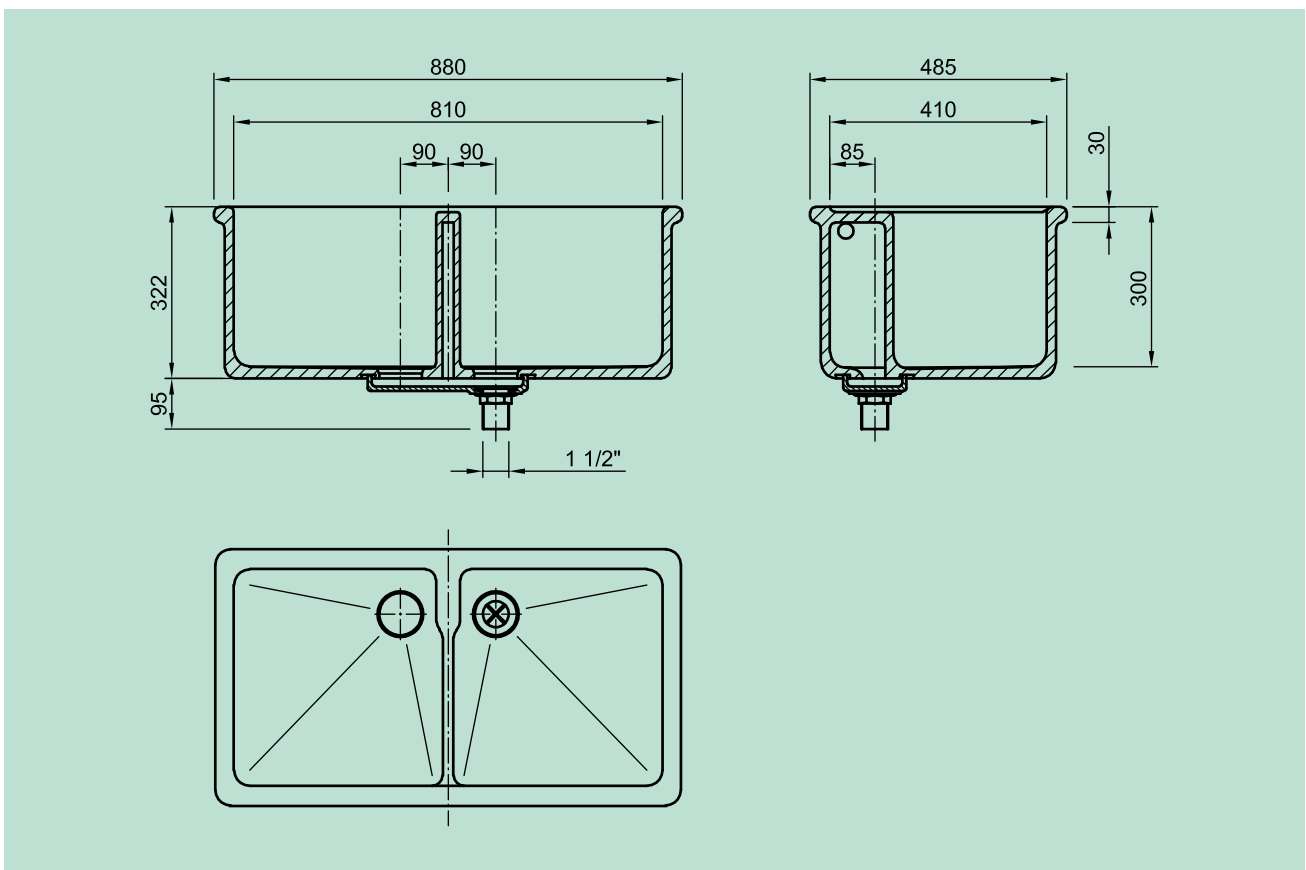

FRIDURIT® Laboratory sinks ■■■

Free-standing sinks

Sinks without overflow

FRIDURIT free-standing sinks without overflow are made from Technical Ceramics (chemical-technical stoneware). They are glazed inside and outside and are equipped with a 1½" PE-outlet and a standpipe.



Internal dims. (in mm)			External dims. (in mm)			Weight	Order code
l	b	t	L	B	h	kg	
500	400	300	576	476	322	35	VBSS543●-OUE
600	400	300	676	476	322	38	VBSS643●-OUE
800	400	300	876	476	322	57	VBSS843●-OUE
1000	400	300	1076	476	322	68	VBSS143●-OUE

● Please attach glaze colour. Sinks are only available uni-coloured.

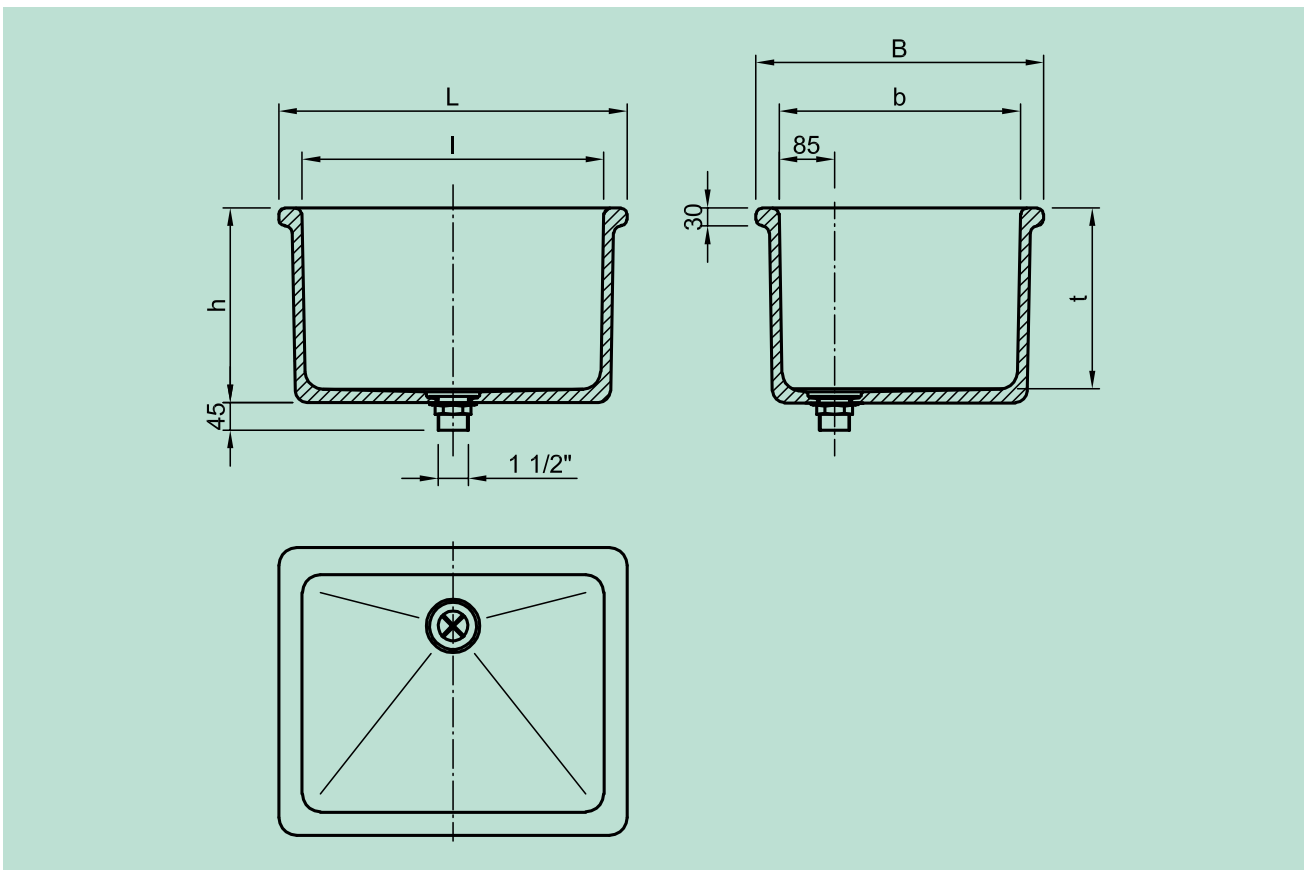

FRIDURIT® Laboratory sinks

Free-standing sinks

Sinks with overflow

FRIDURIT free-standing sinks with overflow are made from Technical Ceramics (chemical-technical stoneware). They are glazed inside and outside and are equipped with a 1½" PE-outlet and a plug.



Internal dims. (in mm)			External (in mm)			Weight kg	Order code
l	b	t	L	B	h		
500	400	300	576	476	322	37	VBSS543●
600	400	300	676	476	322	40	VBSS643●
800	400	300	876	476	322	59	VBSS843●
1000	400	300	1076	476	322	70	VBSS143●

● Please attach glaze colour. Sinks are only available uni-coloured.

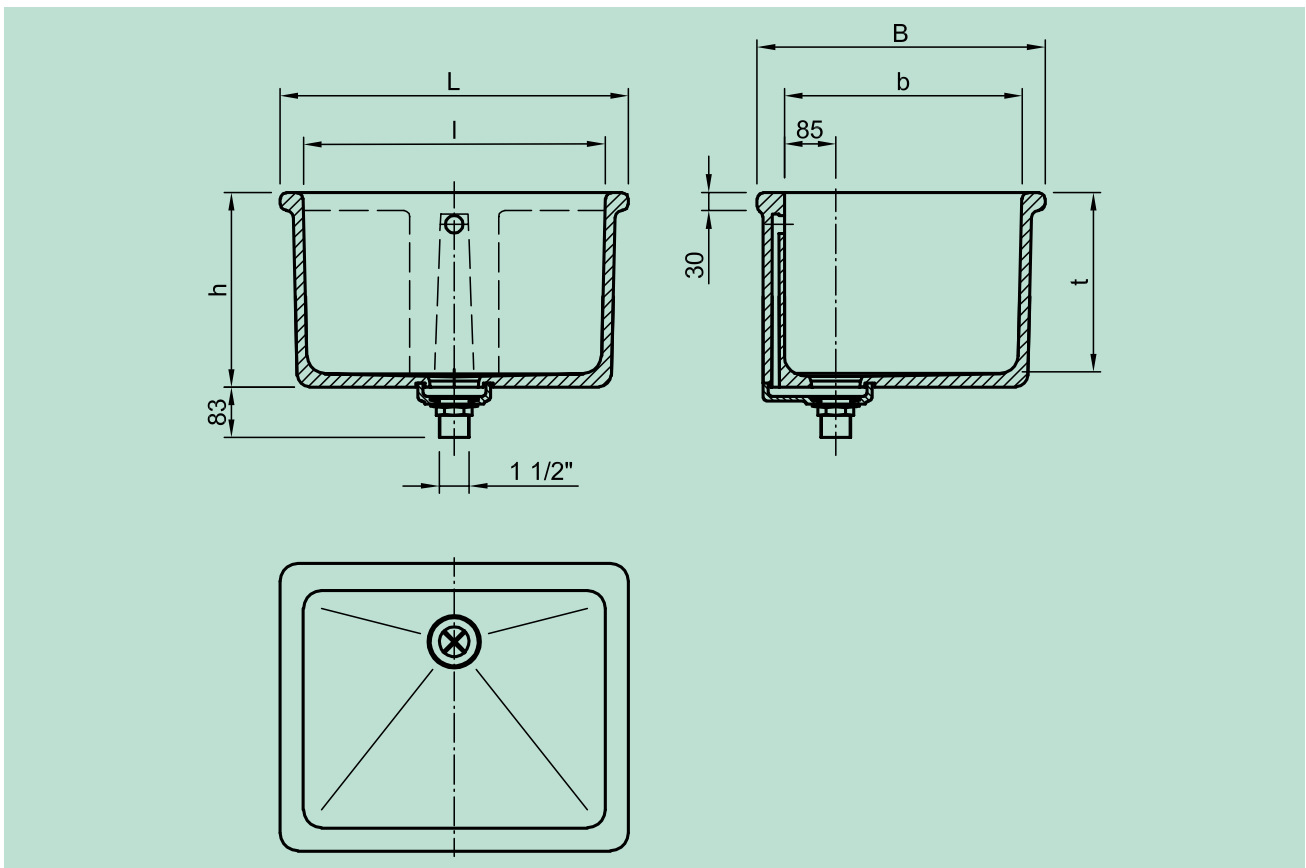

FRIDURIT® Laboratory sinks ■■■

Free-standing sinks

Double sink with overflow

FRIDURIT free-standing double sinks with overflow are made from Technical Ceramics (chemical-technical stoneware). They are glazed inside and outside and are equipped with a 1½" PE-outlet and 2 plugs.



Internal dims. (in mm)			External dims. (in mm)			Weight kg	Order code
l	b	t	L	B	h		
810	410	300	880	485	322	65	VBSD843●

● Please attach glaze colour. Sinks are only available uni-coloured.

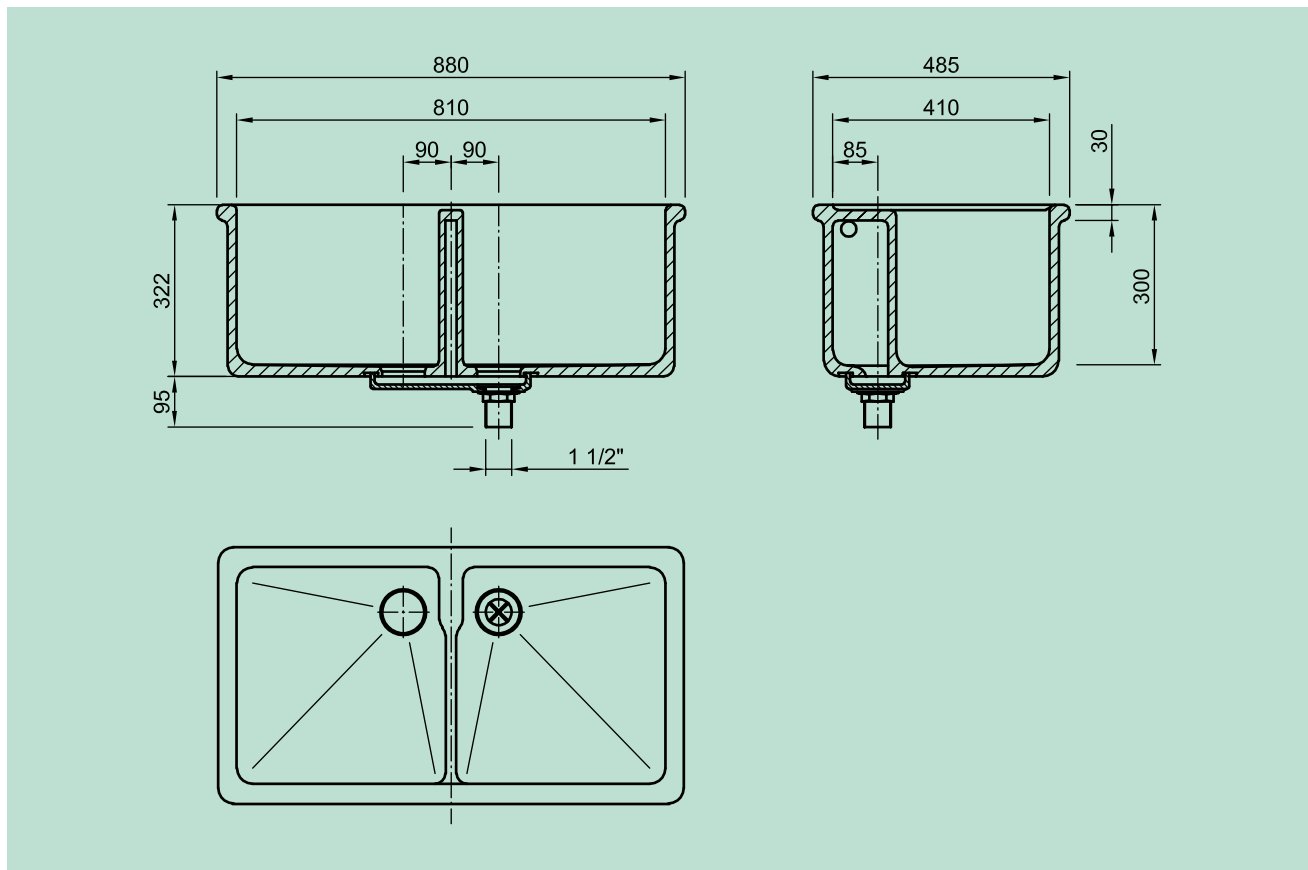

FRIDURIT® Laboratory sinks

FRIDURIT®

Free-standing sinks

Wall sink with overflow

FRIDURIT wall sinks with overflow are made from Technical Ceramics (chemical-technical stoneware). They are glazed inside and outside and are equipped with a 1½" PE-outlet and a plug.



Internal dims. (in mm)			External dims. (in mm)			Weight kg	Order code
l	b	t	L	B	h		
550	350	180	630	430	202	35	VBSW531●

● Please attach glaze colour. Sinks are only available uni-coloured.

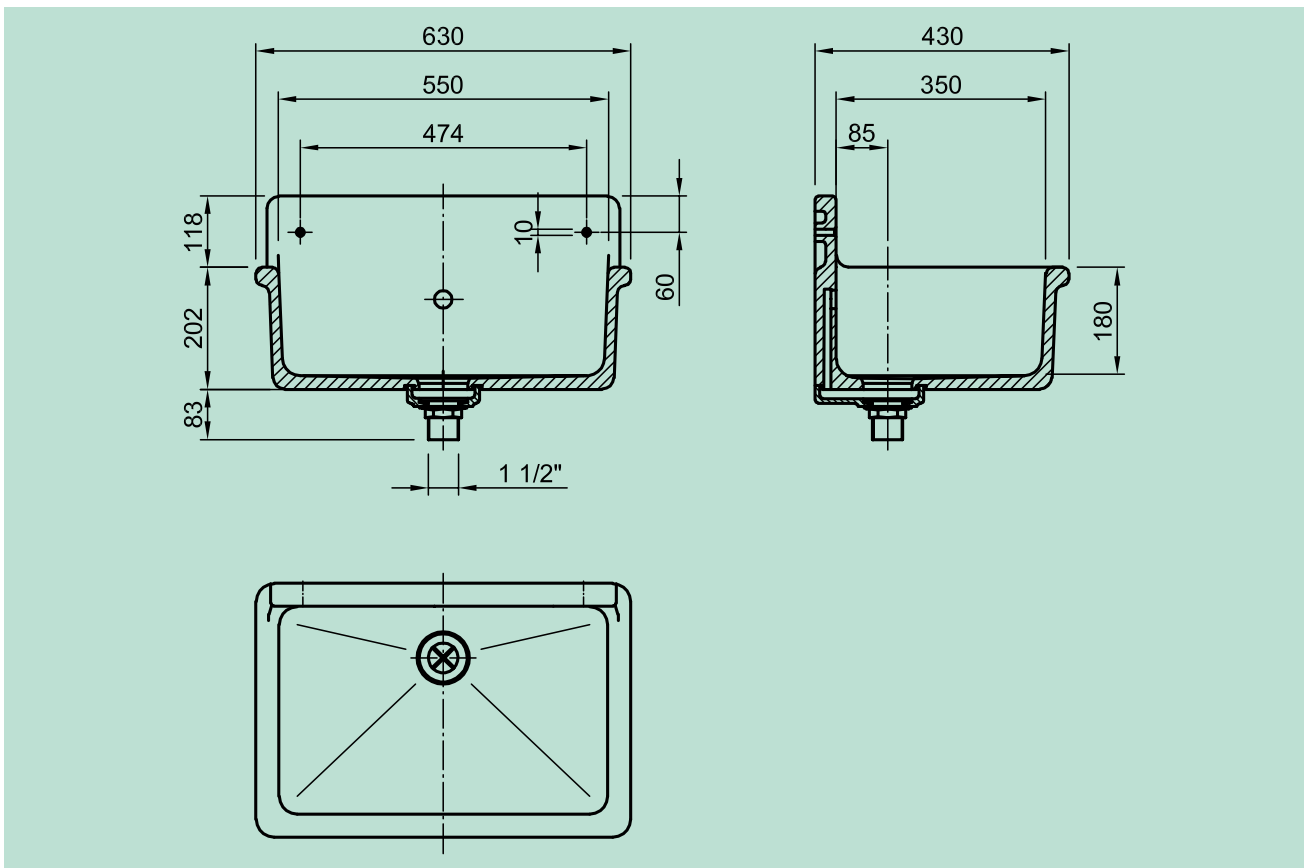

Notes on installation

For sit-on sinks

The sinks can be fitted from above in a cut (unglazed) aperture of a FRIDURIT full-size laboratory benchtop and sealed with silicone. An uncontrolled discharge of fluids in case of spillage is prevented.

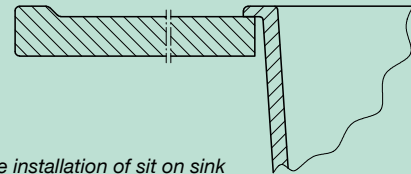

Example installation of sit on sink

For flush-mounted sinks

The sinks can be mounted into a stepped (unglazed) aperture of a FRIDURIT full-size laboratory benchtop and sealed by a flexible (e.g. with silicone) or curing (e.g. with an epoxy adhesive) method. The sealing on the upper face can be cleaned easily.

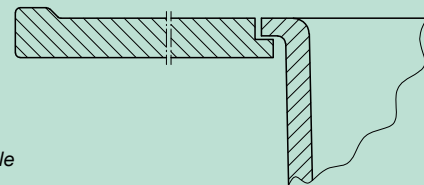

Example installation of flush-mounted sink

For underfixed sinks

The sinks can be permanently bonded to a FRIDURIT full-size laboratory benchtop, e.g. with an epoxy adhesive.

Optionally, the joint between the sink and the benchtop can be filled with a flexible sealant such as silicone rubber. A support for the sink is then required on site.

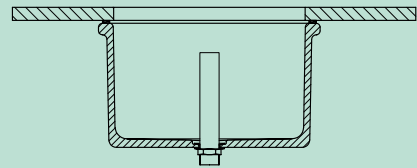

Example installation of underfixed sink, permanently bonded

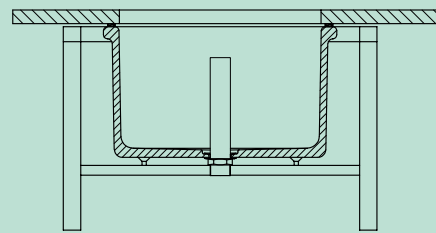

Example installation of underfixed sink with flexible sealant

The positioning of FRIDURIT sit-on, flush-mounted and underfixed sinks in the benchtop is subject to the benchtop supplier's recommendations.

For free-standing sinks

Sinks can be fixed on wall consoles or on foot trestles which have to be provided on site.

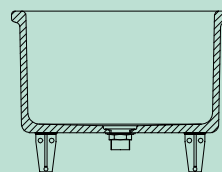

Example installation on wall consoles

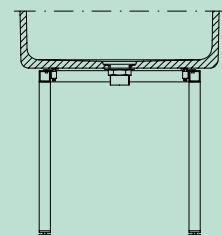

Example installation on foot trestles

■ ■ ■ FRIDURIT® system solutions

Safety and competence for successful laboratory projects

FRIDURIT®



FRIDURIT® laboratory benchtops and sinks

■ made from Technical Ceramics

Highest resistance to virtually all chemicals commonly used in the laboratory. Low-maintenance and reliable due to scratch and abrasion proof surface. Non combustible and 100 % recyclable.

■ made from Polypropylene

Resistant to breakage, welded with no joints and easy to clean.



FRIDURIT® Fume scrubber

Absorbs inorganic contaminants in the waste air from the laboratory

FRIDURIT® Neutraliser unit

For safe neutralisation of laboratory effluent. Fully automatic, quiet and reliable.

FRIDURIT is a registered brand of FRIATEC AG.